



Hakuna Matata

Fenny Marina

£84,950

A 58ft 2004 Anthony 'M'/Jonathon Wilson 4 berth semi-traditional stern narrowboat.

You really would have no worries for the rest of your days with Hakuna Matata! This impeccably presented narrowboat would be perfect as a luxurious floating home or holiday vessel.

Painted in a striking red, white and blue livery, this boats wooden interior is both beautiful and cosy.

As you descend from the stern, you reach the bedroom cabin. This has a fixed double bed and plenty of storage.

Next along is a walkthrough bathroom. This is fitted with a corner shower cubicle, vanity unit and toilet.

A wonderfully well equipped galley is next. This area has a built in oven and fridge, 4 burner gas hob, and a washing machine. There is also plenty of storage boat above and below the lovely black marble worktops.

The last cabin along is the dinette and separate saloon. The dinette can be converted into a double berth if required. The salon has a sofa, TV, WiFi Router and is heated by a Refleks stove.

Ornate bow steps then lead you out on to the bow deck with storage lockers that can be used as bench style seating.

This boat has a bow thruster and a Wi-Fi router.

Hakuna Matata comes with a valid Boat Safety Certificate, valid until May 2028.

Viewing of this boat comes highly recommended. To arrange, or for further information, please call 01527 876438.

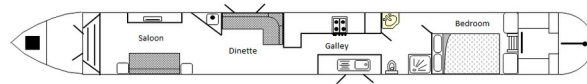

Overall length	58 feet
Beam	6 feet 10 inches
Draft	2 feet 8 inches
Headroom	--
No. of berths	4
Style of stern	Semi-Traditional
BSS certificate expiry	3rd May 2028
Built	In 2004 by Anthony M/Jonathon Wilson
Fitout	In 2004 by Anthony M
Base	Steel 10mm
Hull	Steel 6mm
Cabin	Steel 4mm
Engine	Lister Petter LPWH 40hp
Gearbox	Nawage PRM 150 D2

Scan the QR code to view online





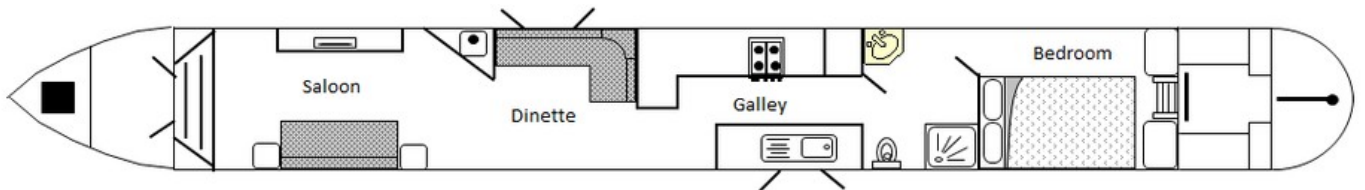



General

General

Name	Hakuna Matata
BW index number	511181
Safety certificate	YES
BSS certificate expiry	3rd May 2028
BSS certificate number	BSSER-476516/24
Built	In 2004 by Anthony M/Jonathon Wilson
Location	Fenny Marina
Price	£84,950

Berths

No. of Berths	4
Double beds	1
Double beds (temp)	1
Single beds	--
Single beds (temp)	--

Size

Overall length	58 feet
Overall beam	6 feet 10 inches
Overall draft	2 feet 8 inches
Style of stern	Semi-Traditional

Structure

Manufacturer

Manufacturer	Anthony M/Jonathon Wilson
Hull ID No.	GB-AMW56006J404
Build date	2004

Original steel thickness

Base	10mm
Hull	6mm
Cabin	4mm

Anodes

Fitted	NO
Date fitted	--
Size	--
No. of anodes	4

Material

Base	Steel
Hull	Steel
Cabin side	Steel
Roof	Steel

Hull blacking

Last hull blacking	2021
Where	Crafted Boats





Running gear

Engine

Make	Lister Petter
Model	LPWH 40hp
Year	2004
Fuel	Diesel
Cooling	Skin Tank
Hours	5109
Last serviced date	2024-02
Last serviced by	Simon Pollard

Gearbox

Make	Nawage
Model	PRM 150 D2
Year	--
Reduction	--
Coupling	--
Shaft diameter	18 x 12
Propellor size	--

Capacities

Fuel	182ltrs
Water	785ltrs
Gas type	LPG

No. of gas cylinders	2
Gas cylinder size	13kg

Interior

Fitted

Fitted by	Anthony M
Date fitted	2004

Materials used

Floor	Karndean
Hull sides	--
Cabin sides	Ash
Deckhead	--
Bulkheads	--
Fittings	--





Equipment

In the galley

Cooker type	Gas
Cooker model	Midi Prima
Fridge type	Shoreline
Fridge model	--
Other	--

Heating

Type	Boiler
Make	Bubble
Model	PJ24
Fuel	Diesel
Other remarks	Serviced July 2024

Hot water

Type	Immersion
Make	--
Model	--
Fuel	Electric
Other remarks	86 Litre capacity calorifier
Additional heating	Refleks Diesel Stove in Saloon

In the bathroom

Bath	--
Shower	Yes
Hip bath	--
Basin	Yes
Toilet type	Waterless
Toilet make	Natures Head
Toilet model	--
Toilet tank capacity	--
Toilet remarks	--

Electrical systems

DC voltage	12v
No. of batteries (start)	1
No. of batteries (domestic)	--
Split charging	--
Other	3 Solar panels 375 watt in total

240 volt electrical systems

Inverter make	Mastervolt
Inverter rating	Mass sine 12/2000
Generator make	Dinawatt Travel Pack
Generator rating	--
Shoreline	YES
Other	--

Other

Additional information

--

